

Simply the best from Germany

KILIA



Mixer-Grinder B 98

Meister Plus

KILIA Fleischerei- und Spezial-
Maschinen-Fabrik GmbH

Christianstraße 160-164
24536 Neumünster • Germany
Tel +49 (0) 4321 3092 00
Fax +49 (0) 4321 3092 88
e-mail kilia@kilia.com
<http://www.kilia.com>

DIN EN ISO 9001
zertifiziert



Zertifikat Nr.

CERT-09475-2000-AQ-ESN-TGA

The **Meister Plus Mixer-Grinder B 98**, is a versatile, efficient and safe machine, especially designed for butcheries, supermarkets, canteen kitchens and meat processing businesses. The Meister Plus Mixer-Grinder is equipped with a 84 litres hopper and two independent drives.

The machine is characterized by the following features:

- For continuous use, the machine is equipped with two ventilated motors, one for the mincing worm and one for the mixing paddle arm. Both motors can operate independently and are equipped with a reverse function.
- The actuation is effected with low noise, maintenance-free reduction gear units.
- Maintenance is made easy, as all mechanical and electrical parts are easily accessible.
- The machine is mounted on four wheels with brake.
- Machine body, worm, worm housing, hopper, paddle and lid are made from stainless steel. They can easily be disassembled for cleaning.
- The electrical devices are integrated in a closed machine body with protection class IP 65
- Start-up, hopper and lid are secured with safety micro switches.
- The machine meets the CE standards for hygiene and safety as well as the specific standards for meat mincers

The mincer is available with 2 cutting sets:

- **Enterprise:** 1 hole plate, 1 self-sharpening knife stainless steel
- **Unger: B 98:** 5 parts stainless steel including two rings

Dimensions in mm:

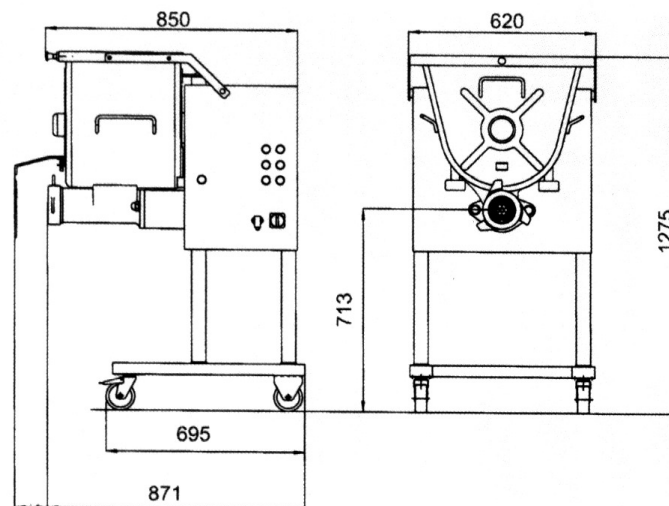

Technical Data:

Meister Plus Mixer-Grinder	B 98
Worm housing, mm	98
Hopper volume, litres	84
Mincing capacity, kg/h (kg/min)	1200 (20)
Mixing capacity (depends on typ of product and particle size), kg	max. 65
Power mincer motor, kW (HP)	3 (4)
Power mixer motor, kW (HP)	1,1 (1,5)
Net weight, kg	200